

Pollution Levels in Surrey Heath over Time

Chart 1

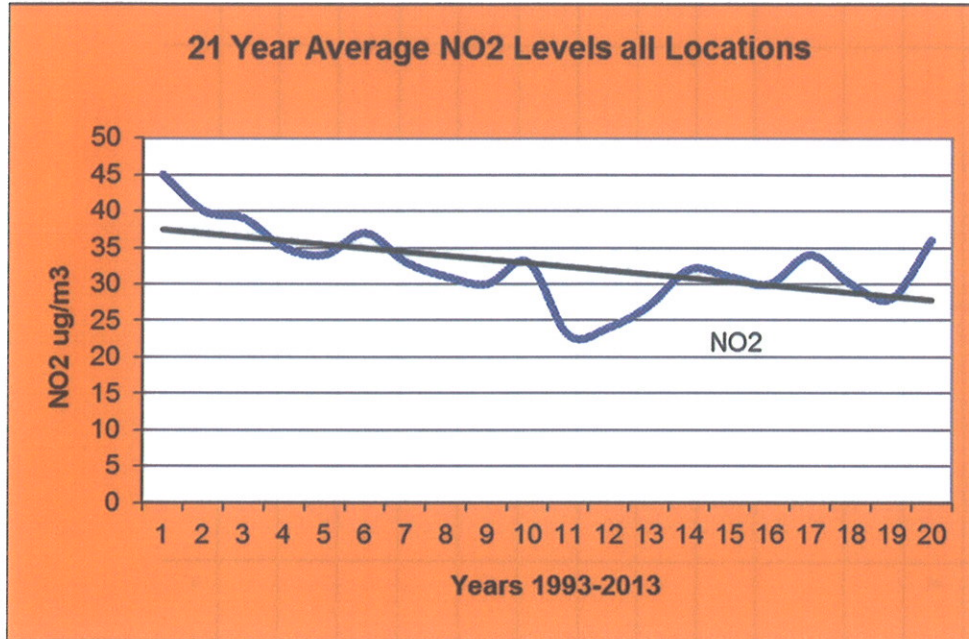

Chart 2. Trends in Annual Mean NO<sub>2</sub> Concentrations Measured at Automatic Monitoring Site

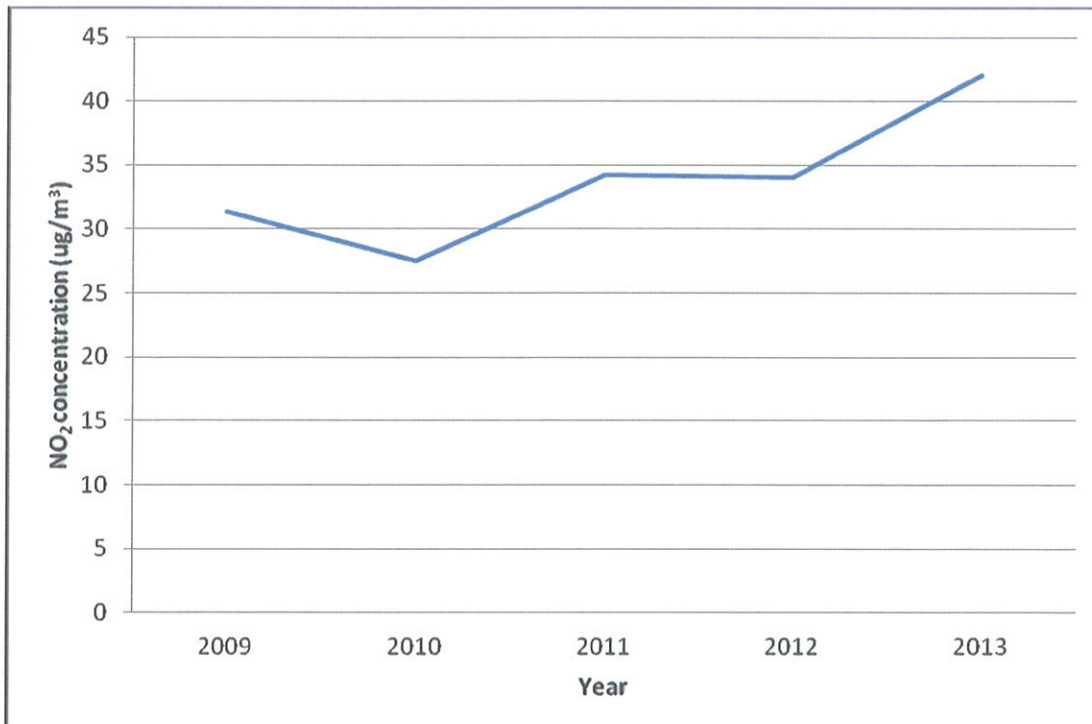

Table 2 NO2 Diffusion Tube Results 2009

Site ID	Site Type	Within AQMA?	Annual Mean Concentration (µg/m <sup>3</sup> ) - Adjusted for Bias				
			2009 (Bias Adjustment Factor = 1.02)	2010 (Bias Adjustment Factor = 1.06)	2011 (Bias Adjustment Factor = 1.06)	2012 (Bias Adjustment Factor = 0.91)	2013 (Bias Adjustment Factor = 1.06)
SH1	Kerbside	N	23.7	28.5	29.6	23.4	31.1
SH2	Roadside	N	21.8	27.2	23.3	22.5	30.5
SH3	Urban Background	N	17.8	22.3	19.1	17.6	23.9
SH4	Roadside	N	16.0	27.0	16.3	15.3	19.4
SH5	Roadside	N	18.5	27.1	32.4	28.1	37.8
SH6	Roadside	N	28.7	30.3	25.7	23.5	37.5 <sup>a</sup>
SH7	Kerbside	N	60.0	71.8	71.4	59.7	41.1 <sup>a</sup>
SH8	Roadside	N	24.0	31.0	32.2	28.0 <sup>b</sup>	31.7 <sup>b</sup>
SH9	Roadside	N	40.5	34.9	25.3	35.5	47.3
SH10	Kerbside	N	30.5	41.7	32.9	32.2	46.1
SH11	Roadside	N	29.2	34.9	30.3	28.9	35.5
SH12	Kerbside	N	30.0	32.9	31.0	25.5	34.0
SH13	Kerbside	N	37.8	47.8	23.7	26.2	32.7

Table 2 NO2 Diffusion Tube Results 2009 to 2013 continued

Site ID	Site Type	Within AQMA?	Annual Mean Concentration ( $\mu\text{g}/\text{m}^3$ ) - Adjusted for Bias				
			2009 (Bias Adjustment Factor = 1.02)	2010 (Bias Adjustment Factor = 1.06)	2011 (Bias Adjustment Factor = 1.06)	2012 (Bias Adjustment Factor = 0.91)	2013 (Bias Adjustment Factor = 1.06)
SH14	Kerbside	Y	29.9	34.3	30.2	29.9	39.5
SH16	Roadside	Y	35.8	37.1	37.7	32.2	40.8
SH17	Kerbside	N	39.8	45.1	23.3	20.1	26.4
SH20	Kerbside	N	25.1	26.7	24.7	23.1	29.8
SH21	Urban Background	N	19.4	24.1	19.7	18.2	26.8
SH23	Kerbside	N	30.0	37.9	35.2	34.0	44.0
SH24	Kerbside	N	28.9	34.4	27.6	24.2	34.2
SH26	Urban Background	N	23.6	29.7	28.6	26.2	29.8
SH27	Kerbside	N	38.9	34.9	21.6	20.5	28.4
SH28	Kerbside	N	23.8	30.9	25.4	27.6	31.9
SH29	Kerbside	N	25.1	25.8	17.2	16.8	22.3
SH30	Roadside	Y	37.3	40.6	37.1	38.7	44.0
SH31	Roadside	Y	31.3	35.0	33.3	27.4	37.6
SH32	Roadside	Y	30.8	27.7	27.8	29.7	34.7
SH33	Roadside	Y	35.8	23.2	33.5	31.6	47.3

Site ID	Site Type	Within AQMA?	Annual Mean Concentration ( $\mu\text{g}/\text{m}^3$ ) - Adjusted for Bias				
			2009 (Bias Adjustment Factor = 1.02)	2010 (Bias Adjustment Factor = 1.06)	2011 (Bias Adjustment Factor = 1.06)	2012 (Bias Adjustment Factor = 0.91)	2013 (Bias Adjustment Factor = 1.06)
SH34	Roadside	Y	27.8	32.3	29.6	26.4	46.4 <sup>a</sup>
SH35	Kerbside	Y	28.5	33.7	26.6	26.2	32.9
SH36	Roadside	Y	27.2	32.1	29.2	26.8	33.7
SH37	Roadside	Y	31.1	35.7	33.0	31.4	34.5
SH38	Urban	N	28.6	36.5	29.3	26.8	36.4
SH15	Roadside	Y	30.7	35.2	32.3	36.6	42.0
SH22	Roadside	Y	33.9	35.6	42.2	33.5	40.9
SH25	Roadside	Y	27.2	34.6	38.6	34.7	42.6
SH15, SH22, SH25	Roadside	Y	30.6	35.1	37.7	34.9	41.8

Map 1 <sup>1</sup> Frimley Receptor Locations 2015. No Speed Limit.  
 Greater than 40ug/m<sup>3</sup> with more than 0.4ug/m<sup>3</sup> detrimental  
 change to those levels before scheme starting.

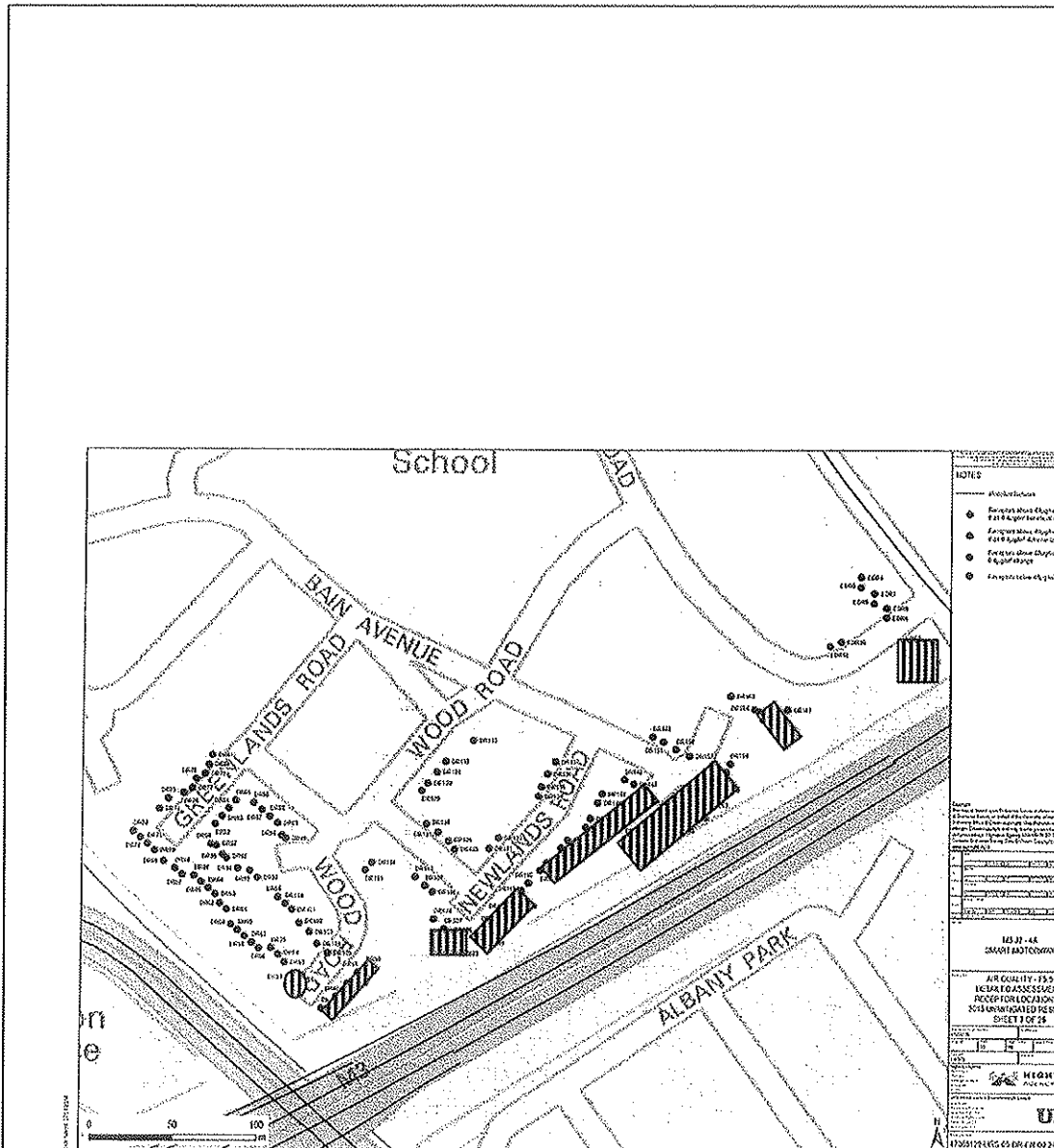

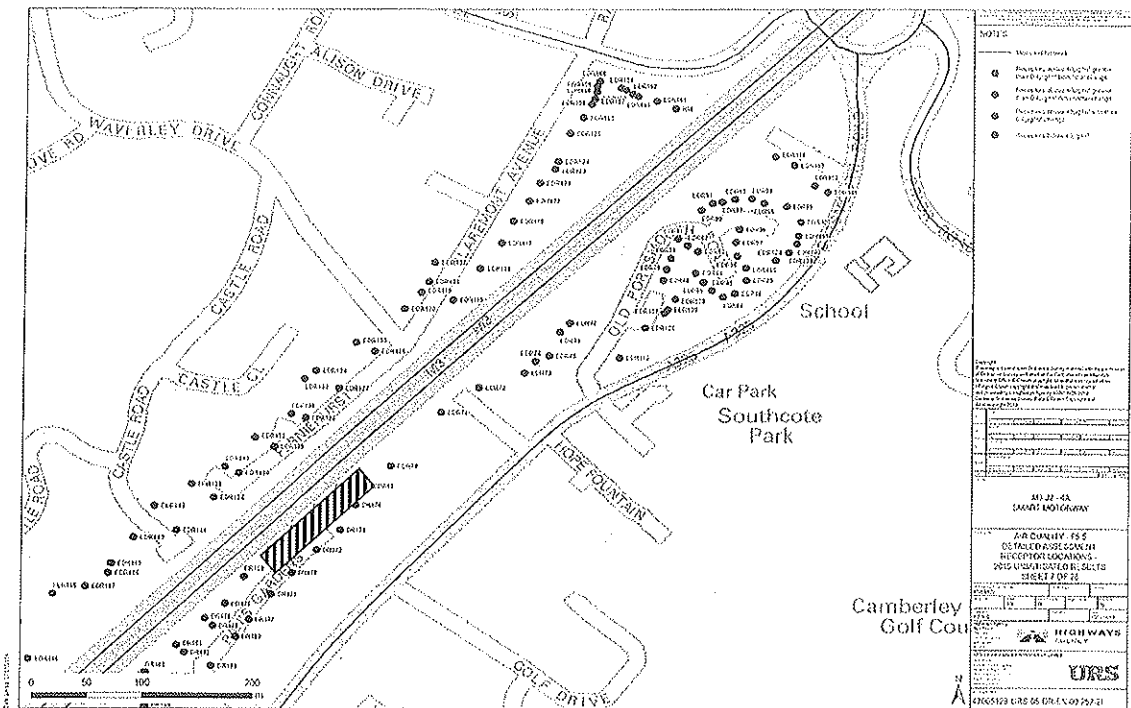



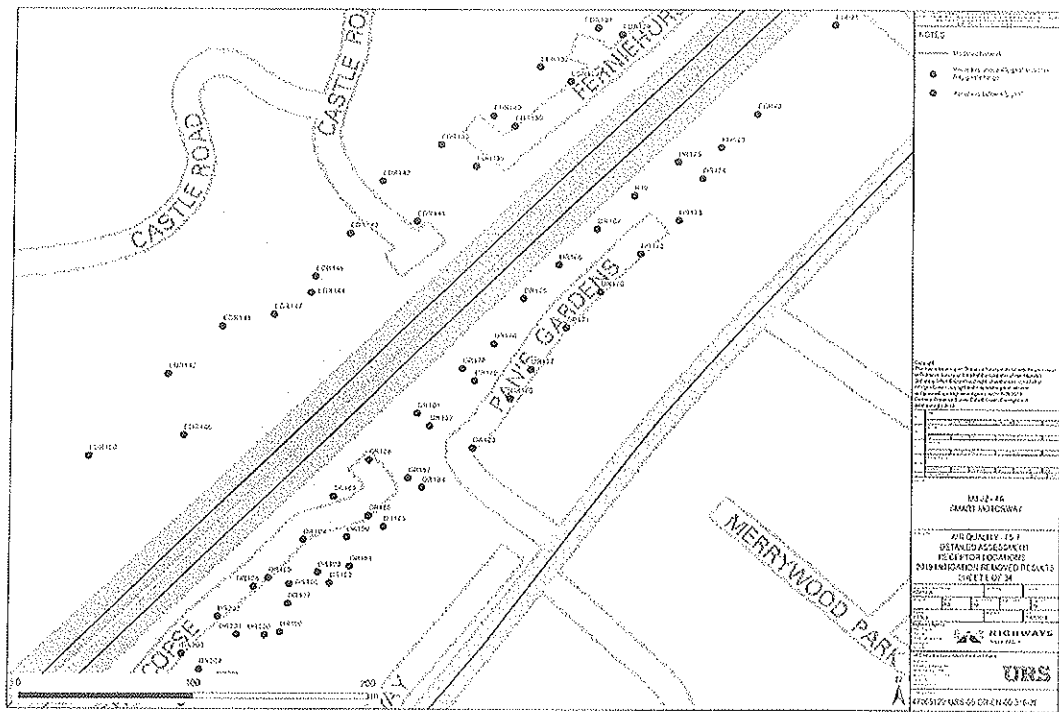

**Map 2 continued**  
 2019 Speed Limit Removed: No exceedence  
 of NO2 limit.